

**UGAM — AMBROLAURI****UGAM AD 2.1 Aerodrome location indicator and name**

UGAM — AMBROLAURI

**UGAM AD 2.2 Aerodrome geographical and administrative data**

1	<b>ARP coordinates and site at AD</b>	423137N 0430808E RWY 11/29 centre
2	<b>Direction and distance from city</b>	1.6 KM NE from Ambrolauri centre
3	<b>Elevation/Reference temperature</b>	1784 FT/29° C
4	<b>Geoid undulation at AD ELEV PSN</b>	71 FT
5	<b>MAG VAR/Annual change</b>	7° E (2021)/NIL
6	<b>AD Administration, address, telephone, telefax, telex, AFS</b>	UNITED AIRPORTS OF GEORGIA  Post: 0198 TBILISI GEORGIA Tel: +995322487300 Email: <a href="mailto:info@airports.ge">info@airports.ge</a> Email: <a href="mailto:ambrolauri@airports.ge">ambrolauri@airports.ge</a>
7	<b>Types of traffic permitted (IFR/VFR)</b>	VFR
8	<b>Remarks</b>	NIL

**UGAM AD 2.3 Operational hours**

1	<b>AD Administration</b>	from 04:30 to 14:30 any day
2	<b>Customs and immigration</b>	NIL
3	<b>Health and sanitation</b>	Health: NIL Sanitation: NIL
4	<b>AIS Briefing Office</b>	NIL
5	<b>ATS Reporting Office (ARO)</b>	NIL
6	<b>MET Briefing Office</b>	NIL
7	<b>ATS</b>	from 04:00 to 14:40
8	<b>Fuelling</b>	NIL
9	<b>Handling</b>	from 04:30 to 14:30 any day
10	<b>Security</b>	H24
11	<b>De-icing</b>	NIL
12	<b>Remarks</b>	NIL

### UGAM AD 2.4 Handling services and facilities

1	<b>Cargo-handling facilities</b>	NIL
2	<b>Fuel/oil types</b>	Fuel: NIL Oil: NIL
3	<b>Fuelling facilities/capacity</b>	NIL
4	<b>De-icing facilities</b>	NIL
5	<b>Hangar space for visiting aircraft</b>	NIL
6	<b>Repair facilities for visiting aircraft</b>	NIL
7	<b>Remarks</b>	NIL

### UGAM AD 2.5 Passenger facilities

1	<b>Hotels</b>	Available in the city
2	<b>Restaurants</b>	Restaurant in the city, cafe at AD and in the city
3	<b>Transportation</b>	Taxis from AD, car rent at AD
4	<b>Medical facilities</b>	First medical aid at hospital in the city
5	<b>Bank and Post Office</b>	Bank in the city Postal Office: NIL
6	<b>Tourist Office</b>	Available in the city and at AD
7	<b>Remarks</b>	NIL

### UGAM AD 2.6 Rescue and fire fighting services

1	<b>AD category for fire fighting</b>	CAT 3
2	<b>Rescue equipment</b>	1 Fire truck
3	<b>Capability for removal of disabled aircraft</b>	Available for L410-UVPE
4	<b>Remarks</b>	Responsible person's details: Mob: +995599263621 E-mail: g.murusidze@airports.ge

### UGAM AD 2.7 Seasonal availability - clearing

1	<b>Types of clearing equipment</b>	Snow removal vehicle - Tractor FENDT 820 VARIO
2	<b>Clearance priorities</b>	1. RWY 11/29 and access roads to the Airport Rescue Service 2. TWY and taxiing paths on the apron 3. Aircraft parking stands and the aerodrome vehicles paths
3	<b>Remarks</b>	The snow plan and friction measuring details see in section AD 1.2.2

### UGAM AD 2.8 Aprons, taxiways and check locations/positions data

1	<b>Apron surface and strength</b>	<b>Designation</b>	<b>Surface</b>		<b>Strength</b>
		APRON	Concrete and asphalt		10/F/B/Y/T
2	<b>Taxiway width, surface and strength</b>	<b>Designation</b>	<b>Width</b>	<b>Surface</b>	<b>Strength</b>
		TWY A	18 M	Concrete and asphalt	10/F/B/Y/T
3	<b>ACL location and elevation</b>	APRON: Elevation 1774 FT			
4	<b>VOR checkpoints</b>	NIL			
5	<b>INS checkpoints</b>	NIL			
6	<b>Remarks</b>	NIL			

**UGAM AD 2.9 Surface movement guidance and control system and markings**

1	<b>Aircraft stand ID signs TWY guide lines Visual docking/parking guidance system</b>	TWY guide lines
2	<b>RWY and TWY markings and LGT</b>	RWY : Designation, THR, centre line, TDZ, edge line marked TWY : Centre line, edge lines, holding position marked
3	<b>Stop bars</b>	NIL
4	<b>Remarks</b>	NIL

**UGAM AD 2.10 Aerodrome Obstacles***In Area 2*

Designator	Type	Coordinates	ELEV	HGT	Marking/LGT type, colour	Remarks
1	2	3	4	5	6	7
UGAM01	Mast	423159.2N 0430716.8E	1915 FT	NIL	NIL	NIL
UGAM02	Mast	423157.5N 0430726.1E	1873 FT	NIL	NIL	NIL
UGAM03	Mast	423154.5N 0430734.8E	1930 FT	NIL	NIL	NIL
UGAM04	Mast	423151.0N 0430746.7E	1885 FT	NIL	NIL	NIL
UGAM05	Mast	423150.2N 0430751.6E	1898 FT	NIL	NIL	NIL

*In Area 3*

Designator	Type	Coordinates	ELEV	HGT	Marking/LGT type, colour	Remarks
1	2	3	4	5	6	7
NIL						

**UGAM AD 2.11 Meteorological information provided**

1	<b>Associated MET Office</b>	Ambrolauri
2	<b>Hours of service MET Office outside hours</b>	From 05:00 - until 13:00 -
3	<b>Office responsible for TAF preparation Periods of validity</b>	Kutaisi - UGKO; From 05:00 - until 17:00
4	<b>Trend forecast Interval of issuance</b>	NIL
5	<b>Briefing/consultation provided</b>	MET staff consultation at Kutaisi UGKO MET Office and Tbilisi UGTB MET Office
6	<b>Flight documentation Language(s) used</b>	Charts, abbreviated plain language text English
7	<b>Charts and other information available for briefing or consultation</b>	S, U85, U70, P85, P70, SWM, T, GAMET, AIRMET
8	<b>Supplementary equipment available for providing information</b>	NIL
9	<b>ATS units provided with information</b>	Ambrolauri AFIS
10	<b>Additional information (limitation of service etc.)</b>	NIL

### UGAM AD 2.12 Runway physical characteristics

RWY Designations	TRUE BRG	Dimensions of RWY	Strength (PCN) and surface of RWY and SWY	THR & RWY end coordinates THR geoid undulation	THR elevation and highest elevation of TDZ of precision APP RWY
1	2	3	4	5	6
11	115.17°	1100 M x 30 M	10/F/B/Y/T Concrete and asphalt	THR: 423144.35N 0430745.82E GUND: 71 FT END: 423129.23N 0430829.47E	THR: 1769 FT TDZ: NIL
29	295.17°			THR: 423129.23N 0430829.47E GUND: 71 FT END: 423144.35N 0430745.82E	THR: 1784 FT TDZ: NIL

Slope of RWY-SWY	SWY dimensions	CWY dimensions	Strip dimensions	RESA dimensions	Arresting System	OFZ	Remarks
7	8	9	10	11	12	13	14
0.40%	NIL	NIL	1220 M x	NIL	NIL	NIL	NIL
-0.40%	NIL	NIL	80 M	NIL	NIL	NIL	NIL

### UGAM AD 2.13 Declared distances

RWY Designator	TORA	TODA	ASDA	LDA	Remarks
1	2	3	4	5	6
11	1100 M	1100 M	1100 M	1100 M	NIL
29	1100 M	1100 M	1100 M	1100 M	NIL

### UGAM AD 2.14 Approach and runway lighting

RWY Designator	APCH LGT type LEN INTST	RTHL colour WBAR	VASIS (MEHT) PAPI	RTZL LEN	RCLL LEN, spacing, colour, INTST	REDL LEN, spacing, colour, INTST	RENL colour, WBAR	STWL LEN, colour	Remarks
1	2	3	4	5	6	7	8	9	10
11	NIL	NIL	NIL	NIL	NIL	NIL	NIL	NIL	NIL
29	NIL	NIL	NIL	NIL	NIL	NIL	NIL	NIL	NIL

### UGAM AD 2.15 Other lighting and secondary power supply

1	ABN/IBN location, characteristics and hours of operation	NIL
2	LDI location and LGT Anemometer location and LGT	NIL NIL
3	TWY edge and centre line lighting	Edge: NIL CL: NIL
4	Secondary power supply/switch-over time	NIL
5	Remarks	NIL

### UGAM AD 2.16 Helicopter landing area

1	<b>Coordinates TLOF or THR of FATO</b>	NIL
	<b>Geoid undulation</b>	NIL
2	<b>TLOF and/or FATO elevation</b>	NIL
3	<b>TLOF and FATO area dimensions, surface, strength, marking</b>	NIL
4	<b>True BRG of FATO</b>	NIL
5	<b>Declared distance available</b>	NIL
6	<b>APP and FATO lighting</b>	NIL
7	<b>Remarks</b>	NIL

### UGAM AD 2.17 Air traffic services airspace

1	<b>Designation, lateral limits, vertical limits</b>	<b>AMBROLAURI FIZ</b> Circle: radius 5 NM, centred at 423137N 0430808E 2000 FT AGL GND
2	<b>Airspace classification</b>	G
3	<b>Call sign</b> <b>Languages</b>	AMBROLAURI INFORMATION English
4	<b>Transition altitude</b>	NIL
5	<b>Remarks</b>	NIL

### UGAM AD 2.18 Air traffic services communication facilities

Service designation	Call sign	Channel	SATVOICE	Logon address	Hours of operation	Remarks
1	2	3	4	5	6	7
AFIS	AMBROLAURI INFORMATION	119.850 MHz	NIL	NIL	04:00 - 14:40	NIL

### UGAM AD 2.19 Radio navigation and landing aids

NIL

### UGAM AD 2.20 Local aerodrome regulations

Local traffic regulations can be obtained on request via email: [info@airports.ge](mailto:info@airports.ge) or by phone (+995) 599263624 or (+995) 599263621.

#### 1 Removal of disabled aircraft from runway

When an aircraft is wrecked on a runway, it is duty of the owner or user of such aircraft to have it removed as soon as possible. If a wrecked aircraft is not removed from the runway as quickly as possible by the owner or user, the aircraft will be removed by the aerodrome authority at the owner's or user's expense.

### UGAM AD 2.21 Noise abatement procedures

NIL

## UGAM AD 2.22 Flight procedures

### 1 General

Flights within Ambrolauri FIZ shall be conducted in accordance with the Visual Flight Rules.

AFIS service is only provided within the operational hours of the unit. Outside the AFIS operational hours only FIS service is available.

The AFIS unit provides aircraft with information on known traffic and available information on meteorological and aerodrome conditions.

### 2 Procedures for IFR flights within Ambrolauri FIZ

Not applicable.

### 3 Radar procedures within Ambrolauri FIZ

Not applicable.

### 4 Procedures for VFR flights within Ambrolauri FIZ

- Flight plans (FPLs) are required to be submitted for operations within Ambrolauri FIZ;
- Flights shall be conducted with vertical visual reference to the ground;
- Two-way radio communication shall be maintained with the Ambrolauri AFIS unit on the unit frequency;
- Inbound aircraft shall establish communication with the AFIS unit 5 minutes before crossing the FIZ boundary. However, contact establishing can be delayed until the moment it becomes practically possible.

### 5 VFR routes within Ambrolauri FIZ

No special arrival and departure routes are established for VFR traffic.

## UGAM AD 2.23 Additional information

Intense activity of small size bird flocks takes place daily from 08:00 to 11:00 (local time) (during summer season from June to September) when birds fly from resting area across the approach of RWY 11 to their feeding area, river. Only small size birds are active, which doesn't effect flight safety if strike to aircraft. Their flight height varies from 328 FT (100 M) to 550 FT (170 M) AGL. From 16:00 to 19:00 (local time) the same activity as described above takes place in reverse when the birds return to their resting area.

Dispersal activities includes shooting sound produced of liquid gas cannons allocated near the RWY 11/29.

Also modifications of the airport environment are under way to reduce, if not eliminate, the wildlife hazard. No landfills in the vicinity and no open waste-bins on the aerodrome. Ground and grass cover is treated properly.

## UGAM AD 2.24 Charts related to an aerodrome

← Aerodrome Chart - ICAO	AD 2.UGAM-ADC
Visual Approach Chart – ICAO	AD 2.UGAM-VAC
Bird Concentrations and Movement	AD 2.UGAM-BIRD

**AERODROME CHART-ICAO**

**AMBROLAURI(UGAM)**

42°31'37"N  
043°08'08"E ELEV. 1784'

AMBROLAURI INFO 119.850

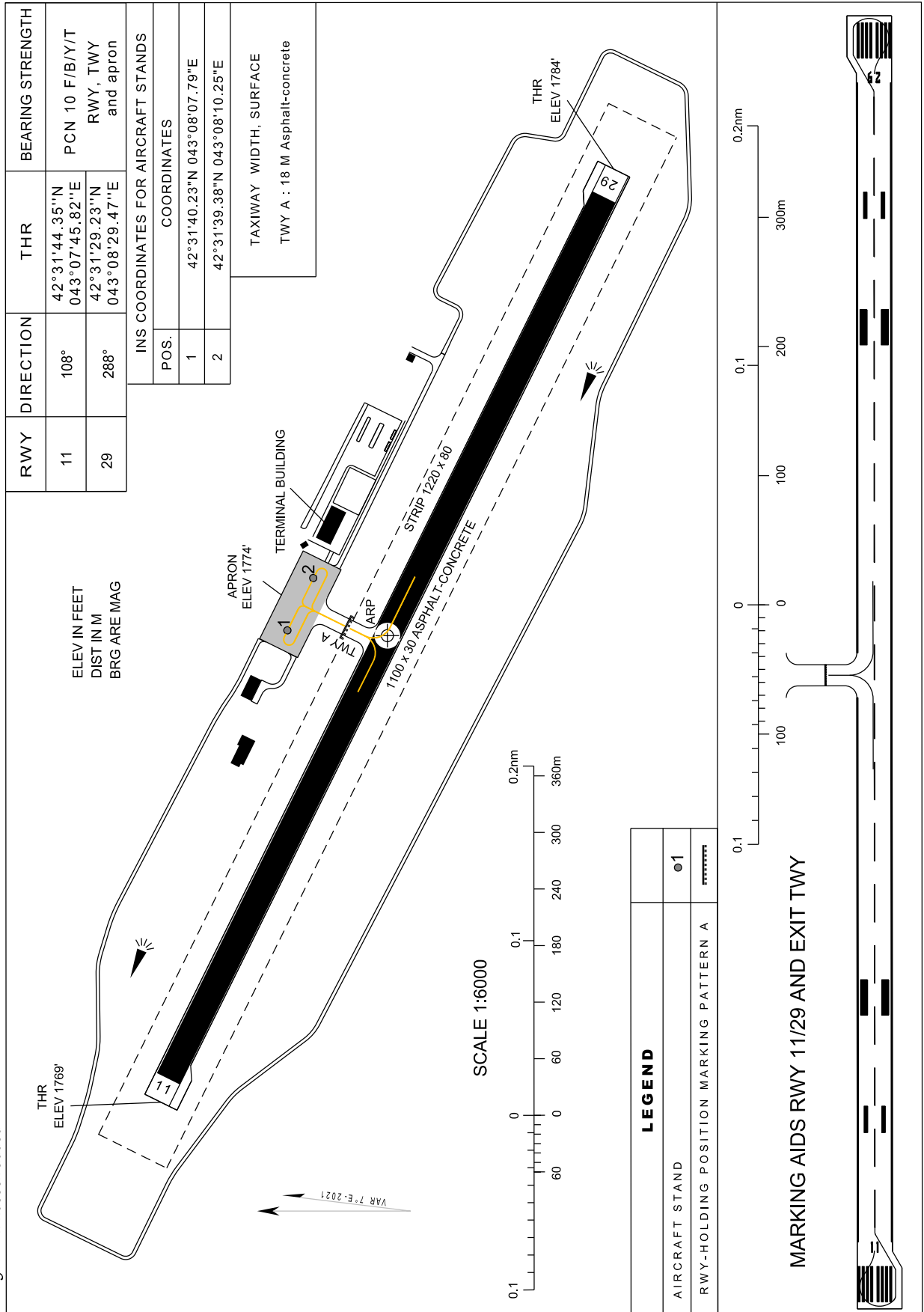

Changes: windsock added

*PAGE INTENTIONALLY LEFT BLANK*

**VISUAL APPROACH CHART - ICAO**

**AMBROLAURI (UGAM)**

AERODROME ELEV. 1784'

AMBROLAURI INFO 119.850

HEIGHTS RELATED TO AD ELEV

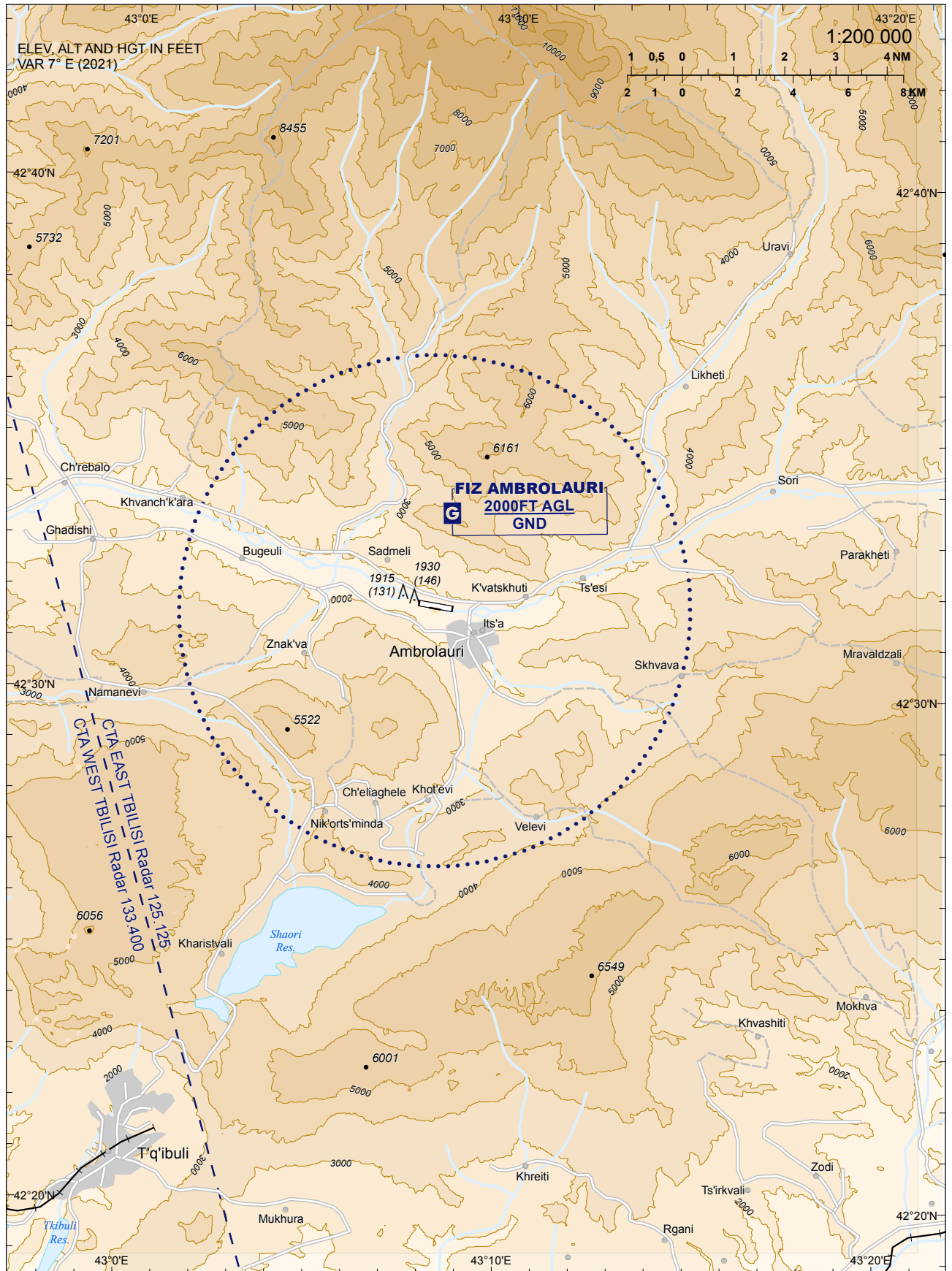

Changes: MAG VAR

*PAGE INTENTIONALLY LEFT BLANK*

BIRD CONCENTRATIONS  
AND MOVEMENT

AMBROLAURI (UGAM)

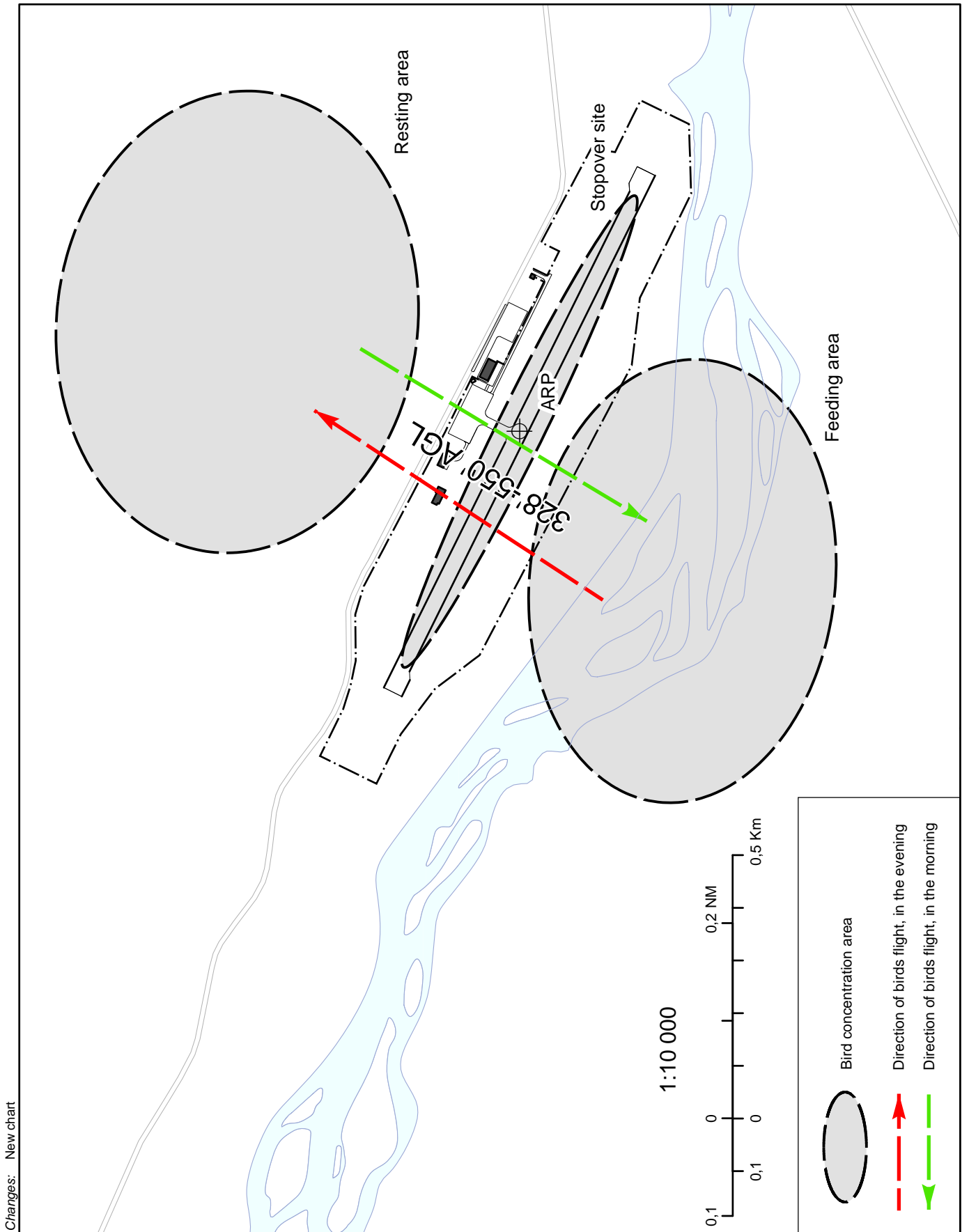

Changes: New chart

*PAGE INTENTIONALLY LEFT BLANK*