

AERODROME CHART - ICAO

BATUMI (UGSB)

41° 36' 37" N
041° 35' 58" E
ELEV. 37'
TWR 118.6

RWY	DIRECTION	THR	BEARING STRENGTH
12	124°	41°37'01"N 041°35'20"E	PCN 35/F/B/X/T RWY, all TWY and apron
30	304°	41°36'08"N 041°36'42"E	

INS COORDINATES FOR AIRCRAFT STANDS					
POS.	COORDINATES		POS.	COORDINATES	
10	41°36'21.27"N	041°36'39.74"E	14A	41°36'25.04"N	041°36'31.63"E
10A	41°36'19.79"N	041°36'41.44"E	15	41°36'25.07"N	041°36'32.19"E
11	41°36'22.34"N	041°36'38.36"E	15A	41°36'25.49"N	041°36'32.26"E
12	41°36'23.41"N	041°36'36.98"E	16	41°36'25.74"N	041°36'33.12"E
13	41°36'24.48"N	041°36'35.60"E	16A	41°36'26.02"N	041°36'32.27"E
14	41°36'24.39"N	041°36'31.26"E			

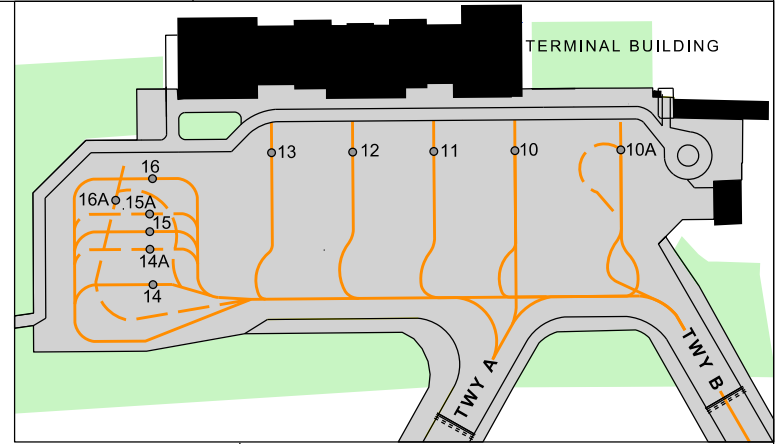
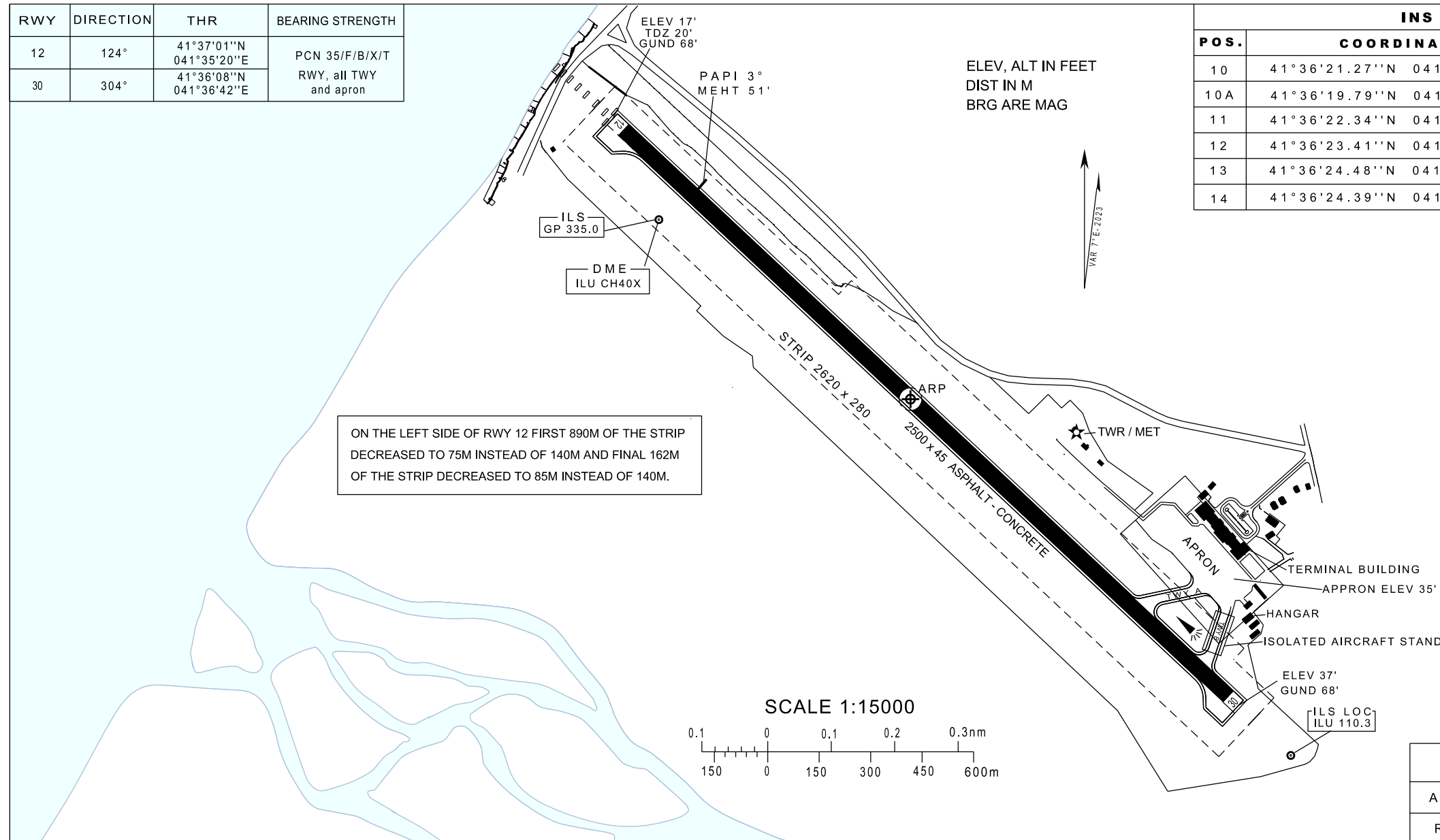

TAXIWAYS WIDTH, SURFACE

TWY A : 23 M Asphalt-Concrete
TWY B : 23 M Asphalt-Concrete

Aircraft stands № 14, 14A, 15, 15A, 16, 16A - Asphalt-PCN 54/F/B/X/T

LEGEND

AIRCRAFT STAND	○13
RWY-HOLDING POSITION MARKING PATTERN A	▬▬▬▬▬▬

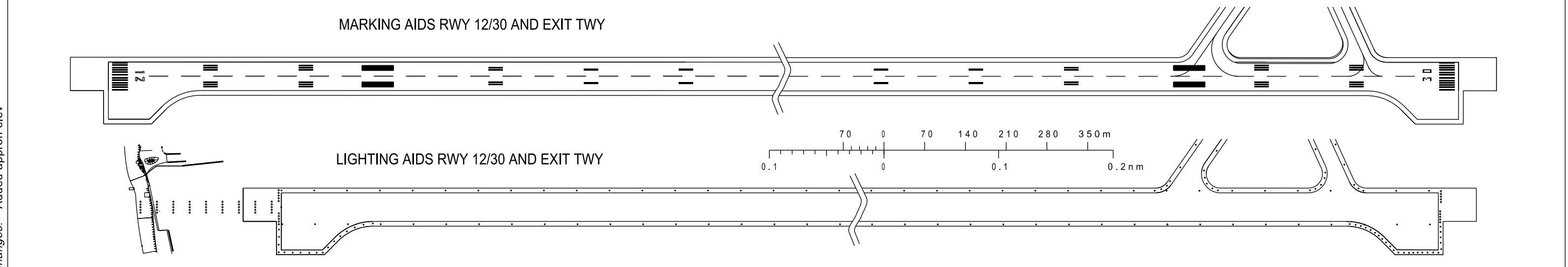

Changes: Added apron elev