

**AIRCRAFT PARKING AND GROUND MOVEMENT
CHART - ICAO**

APRON 4 ELEV 1560'

TWR 119.000 (Primary)
128.000 (Secondary)
APRON 131.700

TBILISI/Tbilisi (UGTB)

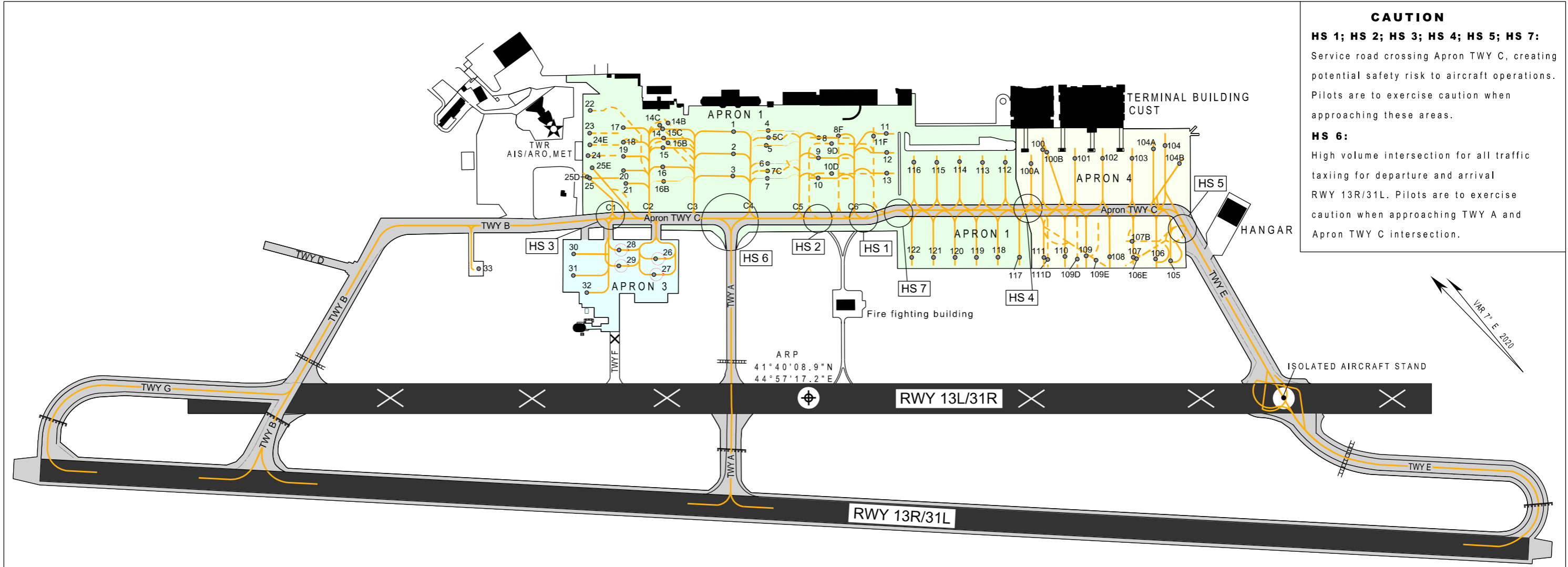

CAUTION
HS 1; HS 2; HS 3; HS 4; HS 5; HS 7:
 Service road crossing Apron TWY C, creating potential safety risk to aircraft operations. Pilots are to exercise caution when approaching these areas.
HS 6:
 High volume intersection for all traffic taxiing for departure and arrival RWY 13R/31L. Pilots are to exercise caution when approaching TWY A and Apron TWY C intersection.

INS COORDINATES FOR AIRCRAFT STANDS

POS.	COORDINATES	POS.	COORDINATES	POS.	COORDINATES	POS.	COORDINATES
1	41°40'24.99"N 044°57'28.44"E	14B	41°40'28.34"N 044°57'24.84"E	27	41°40'21.81"N 044°57'14.84"E	107B	41°40'01.87"N 044°57'47.05"E
2	41°40'23.95"N 044°57'27.10"E	14C	41°40'28.26"N 044°57'24.16"E	28	41°40'24.54"N 044°57'14.11"E	108	41°40'02.10"N 044°57'44.58"E
3	41°40'22.91"N 044°57'25.75"E	15	41°40'27.43"N 044°57'22.99"E	29	41°40'23.80"N 044°57'13.15"E	109	41°40'03.15"N 044°57'43.09"E
4	41°40'23.49"N 044°57'30.70"E	15B	41°40'27.41"N 044°57'23.64"E	30	41°40'26.39"N 044°57'11.01"E	109D	41°40'03.45"N 044°57'42.41"E
5	41°40'22.80"N 044°57'29.79"E	15C	41°40'27.82"N 044°57'23.61"E	31	41°40'25.39"N 044°57'09.70"E	109E	41°40'02.57"N 044°57'43.63"E
5C	41°40'23.14"N 044°57'30.24"E	16	41°40'26.51"N 044°57'21.86"E	32	41°40'23.98"N 044°57'09.52"E	110	41°40'04.15"N 044°57'41.81"E
6	41°40'21.96"N 044°57'28.68"E	16B	41°40'25.85"N 044°57'20.99"E	33	41°40'30.28"N 044°57'03.93"E	111	41°40'05.10"N 044°57'40.47"E
7	41°40'21.27"N 044°57'27.78"E	17	41°40'30.12"N 044°57'21.70"E	100	41°40'10.24"N 044°57'46.86"E	111D	41°40'04.78"N 044°57'40.54"E
7C	41°40'21.61"N 044°57'28.23"E	18	41°40'29.45"N 044°57'20.85"E	100A	41°40'10.17"N 044°57'45.38"E	112	41°40'11.31"N 044°57'43.72"E
8	41°40'20.88"N 044°57'33.45"E	19	41°40'28.78"N 044°57'20.01"E	100B	41°40'09.94"N 044°57'46.97"E	113	41°40'12.33"N 044°57'42.27"E
8F	41°40'19.85"N 044°57'33.89"E	20	41°40'28.11"N 044°57'19.16"E	101	41°40'08.41"N 044°57'48.42"E	114	41°40'13.35"N 044°57'40.83"E
9	41°40'19.94"N 044°57'32.22"E	21	41°40'27.39"N 044°57'18.53"E	102	41°40'07.17"N 044°57'50.16"E	115	41°40'14.38"N 044°57'39.38"E
9D	41°40'20.02"N 044°57'33.91"E	22	41°40'32.47"N 044°57'20.60"E	103	41°40'05.84"N 044°57'52.03"E	116	41°40'15.40"N 044°57'37.93"E
10	41°40'19.00"N 044°57'30.99"E	23	41°40'31.40"N 044°57'19.25"E	104	41°40'04.94"N 044°57'54.84"E	117	41°40'06.13"N 044°57'38.85"E
10D	41°40'18.61"N 044°57'32.13"E	24	41°40'30.43"N 044°57'17.76"E	104A	41°40'05.31"N 044°57'53.91"E	118	41°40'07.09"N 044°57'37.49"E
11	41°40'18.01"N 044°57'37.97"E	24E	41°40'30.82"N 044°57'18.58"E	104B	41°40'03.45"N 044°57'54.66"E	119	41°40'08.06"N 044°57'36.13"E
11F	41°40'18.05"N 044°57'36.44"E	25	41°40'29.37"N 044°57'16.40"E	105	41°39'59.31"N 044°57'48.36"E	120	41°40'09.02"N 044°57'34.77"E
12	41°40'17.11"N 044°57'36.84"E	25D	41°40'29.36"N 044°57'16.50"E	106	41°40'00.00"N 044°57'47.53"E	121	41°40'09.99"N 044°57'33.41"E
13	41°40'16.13"N 044°57'35.60"E	25E	41°40'29.64"N 044°57'17.35"E	106E	41°40'00.88"N 044°57'46.16"E	122	41°40'10.95"N 044°57'32.05"E
14	41°40'28.32"N 044°57'24.08"E	26	41°40'22.49"N 044°57'15.90"E	107	41°40'01.03"N 044°57'46.06"E		

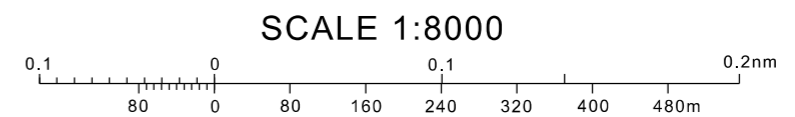

APRON SURFACE & STRENGTH

APRON 1 - Concrete and asphalt - PCN 53/R/B/W/U
 Aircraft stands № 112,113,114,115,116 - Concrete - PCN 62/R/A/W/T
 Aircraft stands № 117,118,119,120,121,122 - Asphalt - PCN 127/F/C/X/T

APRON 3 - Concrete and asphalt - PCN 12/F/B/X/T
 Aircraft Stand 33 - Asphalt - PCN 12/F/B/X/T

APRON 4 - Concrete - PCN 72/R/A/W/T

LEGEND

TAXI LANE	C4
AIRCRAFT STAND	● 23
HELICOPTER STAND	○ 27
RWY-HOLDING POSITION MARKING PATTERN A	▬▬▬▬▬
RWY-HOLDING POSITION MARKING PATTERN B	▬▬▬▬▬▬▬

TAXIWAYS WIDTH, SURFACE & STRENGTH

TWY A :18 M Concrete and asphalt PCN 59/R/B/W/U
 TWY B :23 M Concrete and asphalt PCN 65/R/B/W/U
 Apron TWY C: 23 M Concrete and asphalt PCN 65/R/B/W/U
 TWY D :16 M Concrete PCN 16/R/C/X/T
 TWY E :23 M Concrete PCN 65/R/A/W/U
 TWY F :18 M Concrete and asphalt PCN 12/F/B/X/T
 TWY G :23 M Concrete and asphalt PCN 114/F/C/X/T
 PCN 65/R/A/X/T

Changes: ACFT stands revised, stand 33 PCN added